

**vtech**<sup>®</sup>  
Baby

User's Manual

# Music Mouse Rattle



© 2012 VTech  
Printed in China  
91-002591-001 (英)

**VTech understands that a child's needs and abilities change as they grow and with that in mind we develop our toys to teach and entertain at just the right level...**

## **Electronic Learning Computers**

**Cool, aspirational and inspiring computers for curriculum related learning**

### **vtech Baby**

**Toys that will stimulate their interest in different textures, sounds and colours**

#### **I am...**

...responding to colours, sounds and textures

...understanding cause and effect

...learning to touch, reach, grasp, sit-up, crawl and toddle

### **Pre-School**

**Interactive toys to develop their imagination and encourage language development**

#### **I want...**

...to get ready for school by starting to learn the alphabet and counting

...my learning to be as fun, easy and exciting as can be

...to show my creativity with drawing and music so my whole brain develops

#### **I need...**

...challenging activities that can keep pace with my growing mind

...intelligent technology that adapts to my level of learning

...National Curriculum based content to support what I'm learning at school

4-10 years

Birth-36 months

3-6 years



To learn more about this and other VTech® products, visit [www.vtechuk.com](http://www.vtechuk.com)

# INTRODUCTION

Get ready to shake, rattle and sing with the **VTech® Music Mouse Rattle!** With a large and easy to grasp handle, it's perfect for your baby's little hands. There's a soft plastic cheese in the mouse's hands that's great for teething! There is also a light-up press button and motion sensor that plays phrases, sound effects, a sing-along song and melodies. The sounds encourage motor skill and sensory development whilst entertaining little ones on the move!

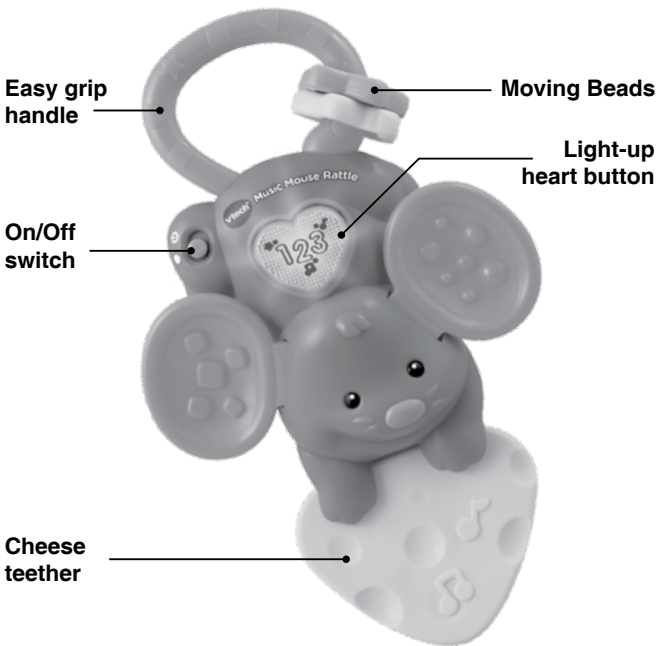

# INCLUDED IN THIS PACKAGE

- One VTech® Music Mouse Rattle learning toy
- One instruction manual

**WARNING:** All packing materials, such as tape, plastic sheets, packaging locks and tags are not part of this toy, and should be discarded for your child's safety.

**NOTE:** Please keep user's manual as it contains important information.

## GETTING STARTED

### BATTERY INSTALLATION

1. Make sure the unit is turned OFF.
2. Locate the battery cover on the back of the unit. Use a screwdriver to loosen the screw.
3. Install 2 new 'AAA' (LR03/AM-4) batteries following the diagram inside the battery box. (The use of new alkaline batteries is recommended for maximum performance.)
4. Replace the battery cover and tighten the screw to secure.

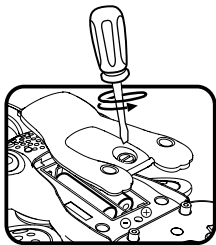

### BATTERY NOTICE

- Use new alkaline batteries for maximum performance.
- Use only batteries of the same or equivalent type as recommended.
- Do not mix different types of batteries: alkaline, standard (carbon-zinc) or rechargeable (Ni-Cd, Ni-MH), or new and used batteries.
- Do not use damaged batteries.
- Insert batteries with the correct polarity.

- Do not short-circuit the battery terminals.
- Remove exhausted batteries from the toy.
- Remove batteries during long periods of non-use.
- Do not dispose of batteries in fire.
- Do not charge non-rechargeable batteries.
- Remove rechargeable batteries from the toy before charging (if removable).
- Rechargeable batteries are only to be charged under adult supervision.

## DISPOSAL OF BATTERIES AND PRODUCT



The crossed-out wheellie bin symbols on products and batteries, or on their respective packaging, indicates they must not be disposed of in domestic waste as they contain substances that can be damaging to the environment and human health.



The chemical symbols Hg, Cd or Pb, where marked, indicate that the battery contains more than the specified value of mercury (Hg), cadmium (Cd) or lead (Pb) set out in Battery Directive (2006/66/EC).

The solid bar indicates that the product was placed on the market after 13th August, 2005.

Help protect the environment by disposing of your product or batteries responsibly.

For more information, please visit:

[www.recycle-more.co.uk](http://www.recycle-more.co.uk)

[www.recyclenow.com](http://www.recyclenow.com)

# ASSEMBLY INSTRUCTIONS

With the **VTech® Music Mouse Rattle** safety comes first. To ensure your child's safety, this product should only be assembled by an adult.

1. To detach the teether for washing loosen the screws then remove the teether.
2. Re-attached the teether by placing it in its original position inside the battery compartment, then screw to secure. Make sure the screws are firmly secure before give the toy to the child.

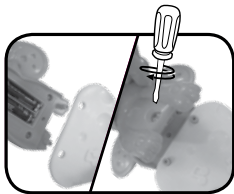
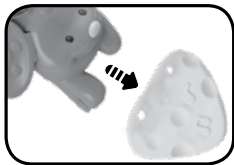

## PRODUCT FEATURES

### 1. ON/OFF SWITCH

To turn the unit **ON**, slide the **OFF/ON SWITCH** to the **ON** (⏻) position. To turn the unit **OFF**, slide the **OFF/ON SWITCH** to the **OFF** (●) position.

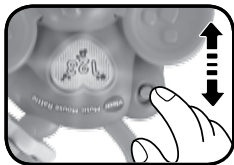

### 2. AUTOMATIC SHUT-OFF

To preserve battery life, the **VTech® Music Mouse Rattle** will automatically power-down after approximately 30 seconds without input in the play mode position. The unit can be turned on again by pressing any button. Please note, activating the motion sensor will not turn the unit back on.

# ACTIVITIES

1. Slide the **On/Off/Switch** to turn the unit on. You will hear a sing-along song and fun phrase. The light will flash with the sounds.
2. Press the **light-up heart button** to hear a sing-along song, melodies, sounds and phrases. The light will flash with the sounds.
3. Activate the **motion sensor** to hear a range of melodies. When a melody is playing shaking the rattle plays sounds over the top of the melody. The light will flash with the sounds.

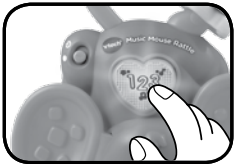
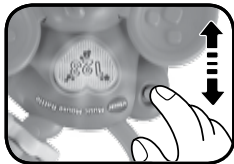

## MELODY LIST

1. Hickory Dickory Dock
2. Three Blind Mice
3. The Bear Went Over The Mountain
4. Hot Cross Buns
5. Jack And Jill
6. Old MacDonald
7. Pop Goes The Weasel
8. Polly Put The Kettle On
9. Twinkle, Twinkle Little Star
10. Did You Ever See A Lassie
11. On Top Of Old Smokey

12. Skip To My Lou
13. Teddy Bears Picnic
14. Oh! Dear, What Can The Matter Be
15. A-ticket, A-tasket
16. Pease Porridge Hot
17. Frere Jacques

## **SONG LYRICS**

### Sung Song 1

I'm a hungry little mouse,  
I smell some cheese,  
Yummy, yummy, cheese!  
Yum, yum, all done

### Sung Song 2

One, two, three, count with me!  
I'm as happy as can be

### Sung Song 3

I like to shake, I like to wiggle,  
Playing with you makes me giggle.

## **CARE & MAINTENANCE**

1. Keep the unit clean by wiping it with a slightly damp cloth.
2. Keep the unit out of direct sunlight and away from any direct heat source.
3. Remove the batteries when the unit will not be in use for an extended period of time.
4. Do not drop the unit on hard surfaces and do not expose the unit to moisture or water.



# TROUBLESHOOTING

If for some reason the program/activity stops working, please follow these steps:

1. Please turn the unit OFF.
2. Interrupt the power supply by removing the batteries.
3. Let the unit stand for a few minutes, then replace the batteries.
4. Turn the unit ON. The unit should now be ready to play again.
5. If the product still does not work, replace with an entire set of new batteries.

If the problem persists, please call our Consumer Services Department on 01235 546810 (from UK) or +44 1235 546810 (outside UK) and a service representative will be happy to help you.

## **IMPORTANT NOTE:**

Creating and developing **VTech®** products is accompanied by a responsibility that we take very seriously. We make every effort to ensure the accuracy of the information, which forms the value of our products. However, errors sometimes can occur. It is important for you to know that we stand behind our products and encourage you to call our Consumer Services Department on 01235 546810 (from UK) or +44 1235 546810 (outside UK), with any problems and/or suggestions that you might have. A service representative will be happy to help you.

**CLASS 1  
LED PRODUCT**



## PRODUCT WARRANTY



Thank you for choosing this quality product from VTech. We hope it will bring many hours of entertainment, imaginative play and learning.

1. The product detailed above is covered by a one year warranty from the date of purchase, against any defects in materials or workmanship.
2. The product may be returned to the place of purchase. Alternatively the product can be returned to VTech Electronics Europe plc (see address below), with proof of purchase, without proof of purchase no replacement will be provided.
3. VTech Electronics Europe plc will examine the product and if it is found to be defective due to faulty materials or workmanship, will replace the product at their discretion.
4. If the product covered by this warranty is damaged due to misuse, modification or unauthorised repair, or because of faulty batteries, battery discharge or incorrect electrical connections, then this warranty becomes void.
5. This warranty is personal to the original purchaser and is not transferable.
6. Breakages to the LCD screen are not covered by the warranty.
7. Returns to VTech Electronics Europe plc should include a cheque or postal order for £1.50 towards the cost of return postage and packaging.
8. Products returned to VTech Electronics Europe plc, should be addressed as follows and packed carefully to avoid damage in transit (Please do not include batteries or adaptor).  
Please include details of the fault together with your name and address.

VTech Electronics Europe plc, c/o Tablogix Limited, 200 Milton Park, Abingdon, Oxon OX14 4TA

**THIS WARRANTY IS OFFERED AS AN EXTRA BENEFIT AND DOES NOT AFFECT CONSUMERS' STATUTORY RIGHTS.**

This warranty is valid for the UK and Eire only. For products purchased outside the UK and Eire, please contact your local distributor or place of purchase.

